

**3.30 IN./130MM
 TORPEDO DIA.
 BIGFOOT**

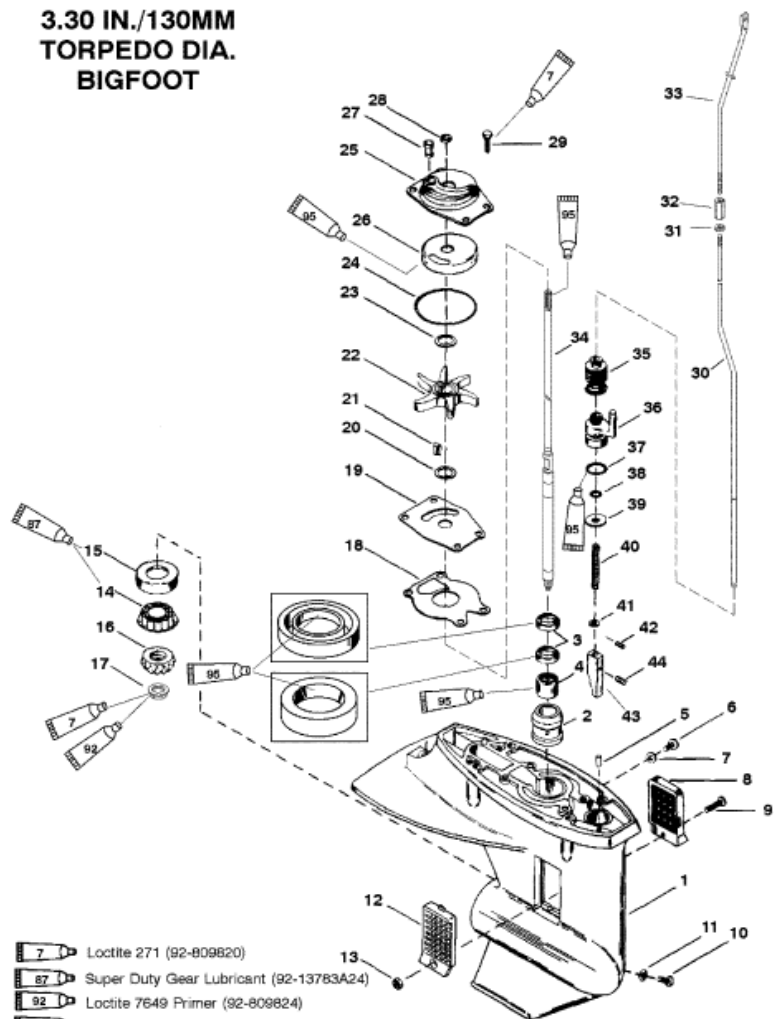

- Loctite 271 (92-809820)
- Super Duty Gear Lubricant (92-13783A24)
- Loctite 7649 Primer (92-809824)
- 2-4-C With Teflon (92-825407A12)

Parts List						
Ref	Class	Part	Description	Qty	Comment	Footnote
-	1665	8669A33	GEAR HOUSING ASSEMBLY	1	(BLACK)	
-	1665	8669A34	GEAR HOUSING ASSEMBLY	1	(GRAY)	
1	1665	8669A21	GEAR HOUSING	1	(BASIC - BLACK)	
1	1665	8669A22	GEAR HOUSING	1	(BASIC - GRAY)	
2		NSS	SLEEVE (INCLUDED W/REF.	1		
3	26	99325	SEAL-GEAR HOUSING	2		
4	31	41326	ROLLER BEARING-UPPER	1		
5	17	85500	DOWEL PIN (.187 X .53)	2		
6	10	79953A 2	SCREW (.375 X .25)	1		
7	12	19183	WASHER-SEALING	1		
8	35	41133	SCREEN-WATER INLET-POR	1		
9	10	40031112	SCREW (M5 X 40)	1		
10	22	67892A 1	DRAIN SCREW-MAGNETIC	1		
11	12	19183	WASHER	1		
12	35	41134	SCREEN-STARBOARD	1		
13	11	40026 3	NUT (M5)	1		
14	31	98294A 1	ROLLER BEARING ASSEMBLY	1		
15		NSS	CUP	1		
16	43	854498	PINION GEAR (12-29)	1		
17	11	828490	NUT	1		
18	27	99326 1	GASKET	1		
19		85083	FACE PLATE	1		
20	12	86645 1	WASHER	1		
21	28	85119	KEY	1		
22	47	85089 3	IMPELLER	1		
23	12	86645 1	WASHER	1		
24	25	69202	O-RING	1		
25	46	99157A 1	WATER PUMP ASSEMBLY	1		
26		NSS	INSERT (INCLUDED W/WATE	1		
27	26	85090	SEAL	1		
28	25	86203	RING	1		
29	10	824832 4	BOLT (M6 X 16)	4		
30		854503	SHIFT SHAFT	1		
31	11	40021 2	NUT (M6)	1		
32		822419	COUPLER	1		
33		852994 1	SHIFT SHAFT (UPPER)	1		
34	45	854501	DRIVE SHAFT	1		
35		85552	BOOT	1		
36		93878	RETAINER	1		
37	25	35276	O-RING	1		
38	25	85594	O-RING	1		